

TILLAMOOK COUNTY SURVEYORS OFFICE
COURT HOUSE, TILLAMOOK, OREGON 97141

C 1/4 CORNER SECTION 11, T.1S., R.8W., W.M.

C 1/4 I found a 1 1/2" iron pipe with a 3" Oregon State
1956 Board of Forestry Bronze Cap. (see T.C.S. Map
RS 359 #A-676) .
I encased the found Iron Pipe and Bronze Cap in a
10" concrete cylinder.

History of found monument

I found this monument to be as described on said T.C.S. Map and the references set at that time to now be as follows:

* (Map #A-676) 28" fir N.84°W. 49.5'; (Found, now a 48" fir, face healed, on the Westerly side of an access road to Demolay Camp Ground) .

* (Map #A-676) 28" fir S.29°W. 51.5'; (Found, now a 41" fir, face healed, on the Westerly side of an access road to Demolay Camp Ground) .

(Rewitness Book 2 Page 370) 15" alder East 39.4'; (Found, now 18" North stem of a double alder, scribing "RS 359" visible) .

4"X 4"X 72" white cedar post 1' NE; (Gone) .

4"X 4"X 72" white cedar post 39.5' South on East edge of park road and North side of Wilson River Highway; (Gone) .

New Accessory

*72" light hat section post North 1.5' .

Surveys and Rewitnesses of record

A-676	Sept. 1956	Arnold G. Gibson	RS 359
A-756	Oct. 1957	Arnold G. Gibson	RS 359
Rewitness Book 2 page 370	10-15-56	Arnold G. Gibson	RS 359
A-1619	Aug. 1968	John L. Carlich	RS 287

Location of Monument

This corner is located approximately 40' Easterly of an access road to Demolay Campground, and approximately 100' North of Wilson River Highway.

In the presence of Al Dvorak and Dan McNutt

May 27, 1992

Title

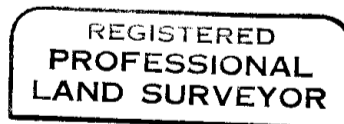

Allan E. Duncan, C.S.

